



The new degree of comfort™

The Rheem Solar Thermosyphon water heater line is engineered for longer life with quality storage tank casing

Performance

- 2.5 - 3 mm metallic storage tank of Rheem Solar Thermosyphon Water Heaters, tested to DIN 4800-5, for much higher resistant to high-pressure water supply networks as most ordinary solar water heaters.
- One single absorber sheet with selective titanium treatment, ultrasonic welded onto copper pipes and solar tempered glass with specialized crystals for minimum sun reflection and higher output.
- Double insulation made from 40mm thick rockwool in the back side and 20mm thick fibre glass placed on the sides, for high performance and minimum heat losses from the collector.

Longer Life

- Rheem Solar Thermosyphon storage tank has an exterior casing made from anodized aluminium, which is extremely durable to ultra-violet rays, resists humid climates, and coastal areas.
- The advanced design of the sealed jacket around the storage tank guarantees the operation of the system in freezing conditions, and also secures the collectors against corrosion and from interior clogging.
- Interior protection of the water tanks with double "direct" glass enamelling baked at 850°C. The tanks has a long life span, even in waters with high salinity content.

Features

- Rheem Solar Thermosyphon Water Heaters can be delivered, upon a special order, with a tube heat exchange built-in to the electric resistance. The tube heat exchanger can be connected with the central heating system achieving more energy saving.
- The Rheem Solar Thermosyphon Water Heaters collector has a special Tempered Glass (4mm thick), to withstand hail and prevent any accidents.
- The excellent outer design of the unit along with the well designed support base, allow for the easy and adjustable installation of the unit on top of tiled or any other type of roofs.
- The side coverings of the collector protect the connection pipes from the ultraviolet rays and offer at the same time a nice aesthetic look that could be incorporated in every architectural building design.
- Magnesium rod offers an additional protection in the tank and its position allows an easy and quick replacement .
- Rheem Solar Thermosyphon Water Heater is manufactured under the strictest international standard specifications and its production is inspected at each production stage. All units have a special identification quality and inspection badge proving they have been inspected to ensure the highest quality.

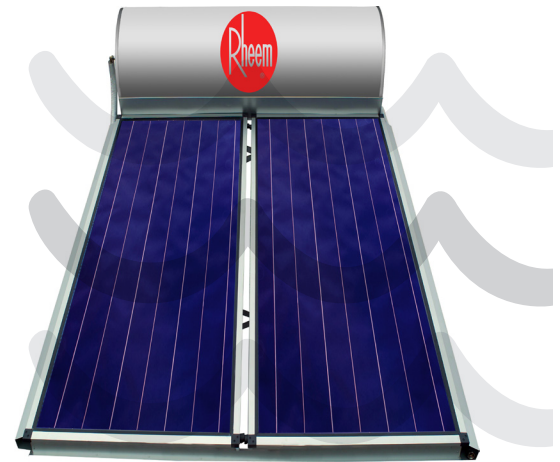

Solar Thermosyphon

120 to 200-Liter Capacities with one collector
 200 to 300-Liter Capacities with two collectors
 10 BAR Pressure Tested Closed Circuit Natural Circulation



EXTERNAL DIMENSIONS - ALL MODELS

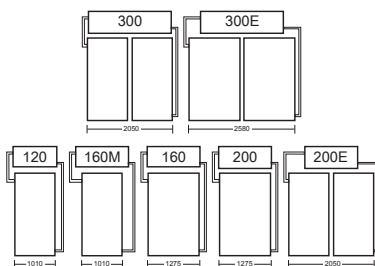

EXTERNAL DIMENSIONS - ALL MODELS

Rheem MODEL	STORAGE TANK			COLLECTOR				SUPPORT BASE		TOTAL WEIGHT	
	Dimensions mm	Weight kg	Cylinder pressure test	Dimensions mm	Collectors	Surface	Weight kg (per collector)	Préastre	Weight kg	EMPTY kg (+/-5%)	FULL kg
120	530x1100	52	10 BAR	2050x1010x90	1	2,10	43	10 BAR	26	121	218
160M	530x1320	62	10 BAR	2050x1010x90	1	2,10	43	10 BAR	26	131	274
160	530x1320	62	10 BAR	2050x1275x90	1	2,60	51	10 BAR	27	140	283
200	570x1320	70	10 BAR	2050x1275x90	1	2,60	51	10 BAR	27	148	321
200E	570x1320	70	10 BAR	2050x1010x90	2	4,20	43	10 BAR	28	184	350
300	570x2050	114	10 BAR	2050x1010x90	2	4,20	43	10 BAR	30	230	522
300E	570x2050	114	10 BAR	2050x1275x90	2	5,20	51	10 BAR	30	246	536

In keeping with its policy of continuous progress and product improvement, Rheem reserves the right to make changes without notice.

Rheem Manufacturing MEA FZE
 Dubai Airport Free Zone - Dubai, UAE
www.rheem-mea.com



INTEGRATED HOME COMFORT

TECHNICAL SPECIFICATIONS OF THE STORAGE TANK CLOSED CIRCUIT TANK (INDIRECT)

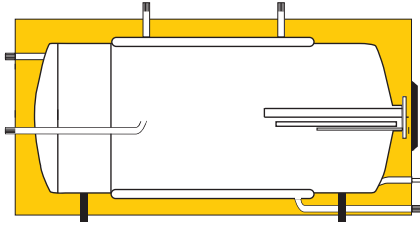

- External casing : anodized aluminium
- Tank's insulation : polyurethane foam 40-60 mm
- Cylinder's material : low carbon steel 2,5 mm
- Jacket's material : low carbon steel 1,5 mm
- Cylinder Internal Protection : glass enameling
- Additional protection : magnesium rod
- Electric resistance : copper
- Thermostat : bipolar of four contacts
- Power rate : available from 0,8kw – 4kw

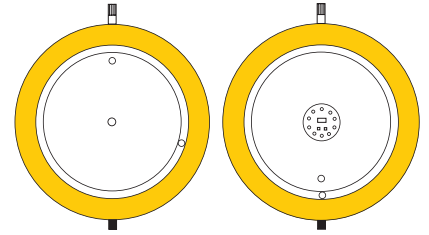

TECHNICAL SPECIFICATIONS OF THE STORAGE TANK OPEN CIRCUIT TANK (DIRECT)

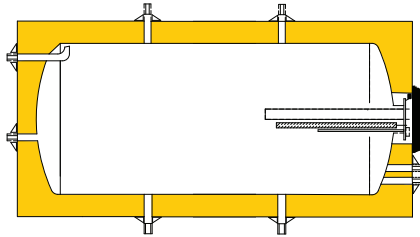

- External casing : anodized aluminium
- Tank's insulation : polyurethane foam 40-60 mm
- Cylinder's material : low carbon steel 2,5 mm
- Cylinder Internal Protection : glass enameling
- Additional protection : magnesium rod
- Electric resistance : copper
- Thermostat : bipolar of four contacts
- Power rate : available from 0,8kw – 4kw

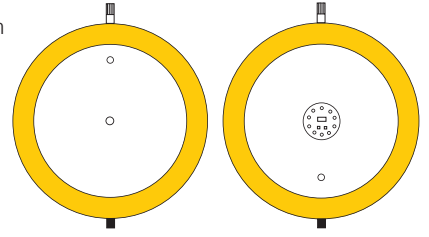

TECHNICAL SPECIFICATIONS OF THE COLLECTOR

1. External frame : anodized aluminium profile
2. Back side : galvanized sheet - 0,4 mm
3. Back insulation : rock wool 35 mm
4. Side insulation : glass-wool of 20 mm
5. Absorber : one piece plate sheet with selective titanium treatment
6. Absorber's tubes : copper pipes, Risers $\varnothing 10$ & Headers $\varnothing 22$
7. Cover : solar tempered glass
8. Water-tightness : EPDM rubber/transparent silicone

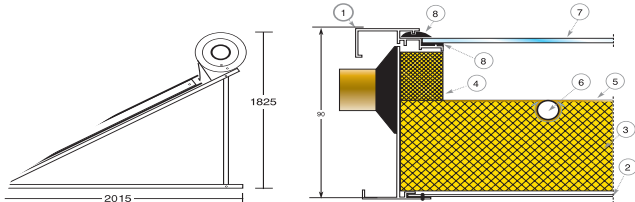

Collector
with titanium



EXTERNAL DIMENSIONS - ALL MODELS

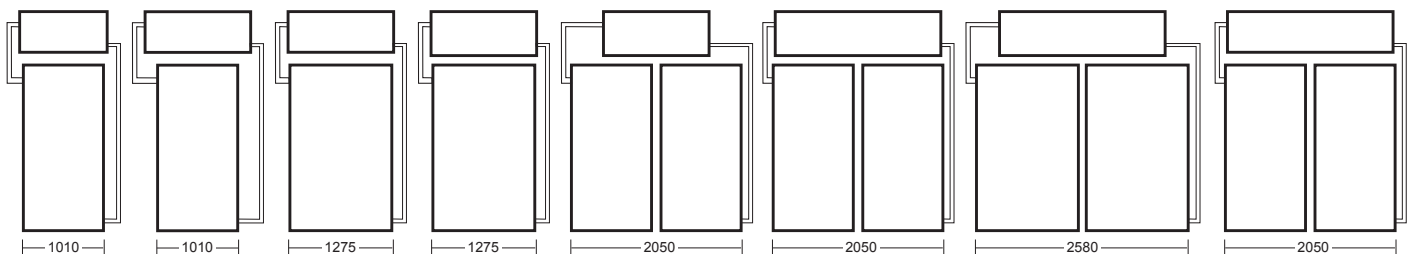

EXTERNAL DIMENSIONS - ALL MODELS

Rheem MODEL	STORAGE TANK			COLLECTOR					SUPPORT BASE	TOTAL WEIGHT
	Dimensions mm	Weight kg	Cylinder pressure test	Dimensions mm	Collectors	Surface	Weight kg (per collector)	Pressure test	Weight kg	EMPTY kg
120	530x1100	48	10 BAR	2050x1010x90	1	2,10	36	10 BAR	24	108
160M	530x1320	59	10 BAR	2050x1010x90	1	2,10	36	10 BAR	24	119
160	530x1320	59	10 BAR	2050x1275x90	1	2,62	45	10 BAR	24	128
200	570x1320	65	10 BAR	2050x1275x90	1	2,62	45	10 BAR	24	134
200E	570x1320	65	10 BAR	2050x1010x90	2	2,10	36	10 BAR	26	163
300	570x2050	110	10 BAR	2050x1010x90	2	2,10	36	10 BAR	32	214
300E	570x2050	110	10 BAR	2050x1275x90	2	2,62	45	10 BAR	32	232